

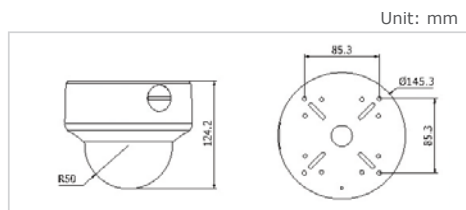

## DS-2CC5173P(N)-VP(IR)-(-H) Vandal Proof & Weather Proof Dome Camera

- 1/3" SONY Super HAD CCD II
- True day & night
- OSD menu
- 3D digital noise reduction
- Digital wide dynamic range
- Dual power supply option (12 V DC / 24 V AC )
- IP66
- Vandal proof

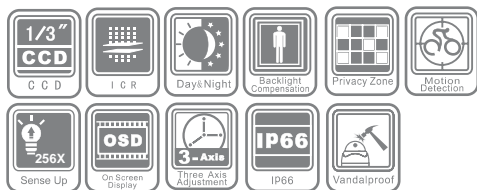

### Specifications

		DS-2CC5173P(N)-VP(IR)-(-H)
Camera	Image Sensor	1/3" SONY Super HAD CCD II
	Signal System	PAL/NTSC
	Effective Pixels	PAL: 752 (H) × 582 (V); NTSC: 768 (H) × 494 (V)
	Min. Illumination	Color: 0.1 Lux @ (F1.2, AGC ON), 0.0003 Lux @ (F1.2, AGC ON, sensitivity × 256) Color: 0.14 Lux @ (F1.4, AGC ON), 0.0004 Lux @ (F1.4, AGC ON, sensitivity × 256) B/W: 0.01 Lux @ (F1.2, AGC ON), 0.00003 Lux @ (F1.2, AGC ON, sensitivity × 256) B/W: 0.014 Lux @ (F1.4, AGC ON), 0.00004 Lux @ (F1.4, AGC ON, sensitivity × 256)
	Shutter Time	PAL: 1/50 s to 1/100,000 s; NTSC: 1/60 s to 1/100,000 s
	Lens	2.8 - 12 mm @ F1.4; Angle of view: 92° - 27.2°
	Lens Mount	Φ14
	Auto Iris	DC drive
	Angle Adjustment	Pan: 0 - 355°, Tilt: 0 - 80°, Rotation: ± 90°
	Day & Night	IR cut filter with auto switch
	Horizontal Resolution	560 TVL (Color), 600 TVL (B/W)
	Synchronization	Internal / Power synchronization
Video Output	1Vp-p composite output (75 Ω / BNC); Test monitor out [1Vp-p composite output (75 Ω / BNC), device line]	
S/N Ratio	More than 52 dB	
Menu	Camera ID	On / Off (15 letters, adjusted position)
	Auto Gain	Low / Middle / High / Off
	D/N Mode	Auto 1 / Auto 2 / Day / Night
	Auto White Balance	Auto 1 / Auto 2 / Manual / Auto control
	Privacy Mask	On / Off, maximum 8 zones
	Motion Detection	On / Off
	BLC	On / Off
	WDR	Indoor / Outdoor / Off
	Anti-flicker	On / Off
Language	English / Chinese	
Video	Gamma Correction, Digital Zoom, Digital Noise Reduction, POS/NEG, Mirror, Resolution, Y, C, Blemish Detection	
General	Operating Conditions	-10 °C - 60 °C (14 °F - 140 °F); Humidity 90% or less (non-condensing) -H: -40 °C - 60 °C (-40 °F - 140 °F) with heater and fan on
	Power Supply	24 V AC ± 10%, 12 V DC ± 10%; -H: 24 V AC ± 10%
	Weather Proof Rating	IP66
	Heater	-H: support
	IR Range	-IR: approx 20 to 30 meters
	Power Consumption	Max. 4 W; -IR: Max. 12 W with IR cut filter on; -H: Max. 24 W with heater and fan on
	Impact Protection	IEC60068-2-75 test, Eh, 50J; EN50102, up to IK10.
	Dimension	Φ 145.3 × 124.2 mm (Φ 5.72" × 4.89")
Weight	2000 g (4.40 lbs)	

### Available Models

PAL: DS-2CC5173P-VP, DS-2CC5173P-VP-IR, DS-2CC5173P-VP-H, DS-2CC5173P-VP-IR-H;  
NTSC: DS-2CC5173N-VP, DS-2CC5173N-VP-IR, DS-2CC5173N-VP-H, DS-2CC5173N-VP-IR-H;